

TSL.680

Waste Drain

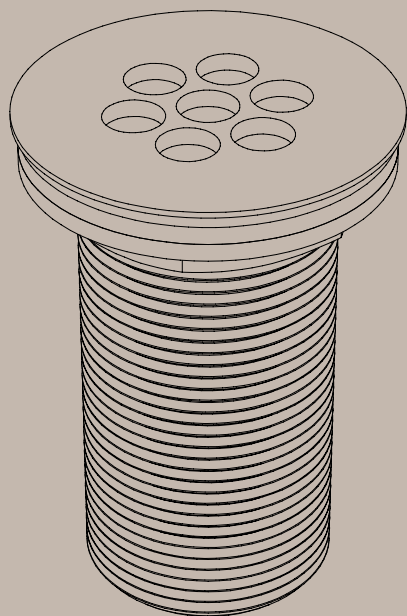

installation + maintenance

+ THE
SPLASH
LAB

contents

3	Safety and Warnings	
4	Box Contents	
5	Diagram	
6	Technical Data	
7	Before you install	
8	How to Install	
9	Maintenance	
10	Cleaning	
11	Warranty	
12	Contact Details	

TSL.680 waste grate

Read and save these instructions

WARNING 

- + Use this unit only in the manner intended by the manufacturer. If you have questions, contact the manufacturer (see back page for more details).
- + Ensure plumbing is installed correctly before activating water supply.
- + All plumbing is to be installed in accordance with applicable codes and regulations.

For more information contact:

Tel: +44 (0)161 482 7000

Email: technical@thesplashlab.com

box contents

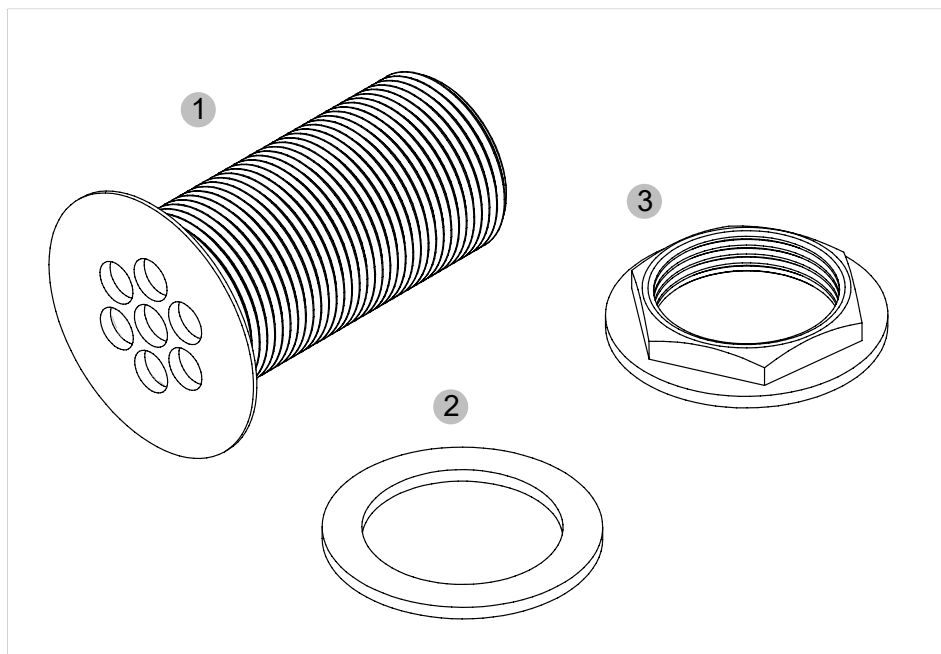

- | | |
|---|---------------|
| 1 | Main body |
| 2 | Rubber Washer |
| 3 | Fixing Nut |

diagram

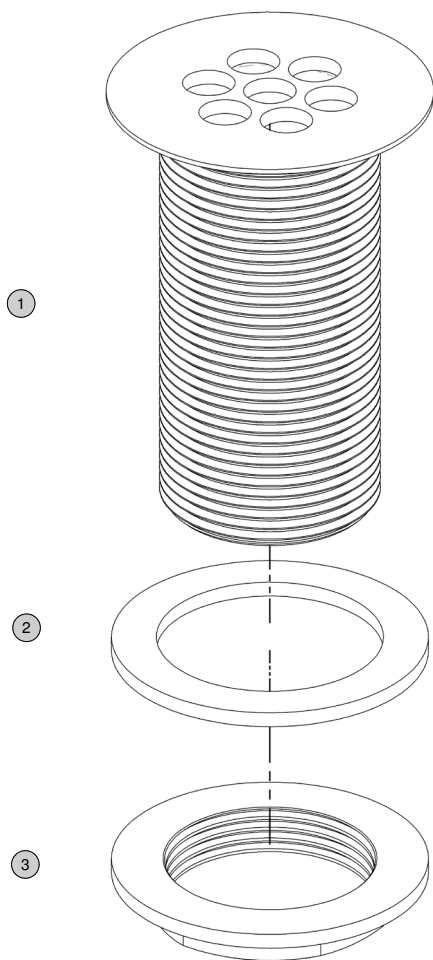

technical data

Overview

The stainless steel waste grate is an unslotted waste grate, with 7 draining holes and a 1 ¼" pipe connection. This requires no action by the user.

Codes	Finishes	Light Reflectance Value (LRV)
TSL.680CS	Brushed Stainless Steel	58
TSL.680CP	Brushed Copper	19
TSL.680BK	Brushed Black	3
TSL.680BR	Brushed Brass	40
TSL.680BZ	Brushed Bronze	17

Technical Data Mechanical

Body Material	AISI 304 Stainless Steel
Coating Type	PVD (colours only)
Weight	0.33Kg
Stainless Steel Grade	304
Flange Diameter	62mm
Length	88mm
Pipe Connection	1 ¼" BSP

Spare Parts

There are no user serviceable parts.

Dimensions

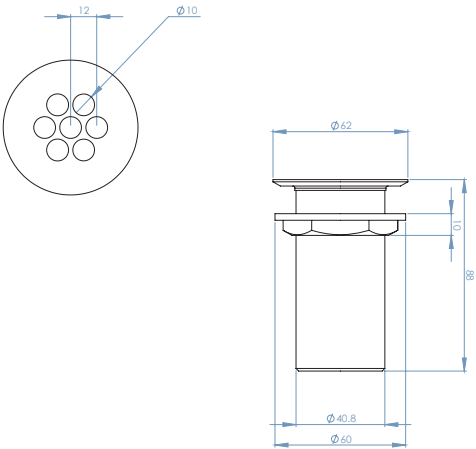

before you install

Caution



- + The TSL.680 parts must be put together correctly before installation.
- + All parts must be installed correctly before powering up the system.
- + Ensure that connection is to 1 ¼" standard waste pipe.
- + Ensure that the thread on the basin waste fitting is clear for trap to be screwed tight and connection sealed.

Access Requirements

It is critical all components which require fixing beneath the basin are easily accessible at all times during installation and routine maintenance.

Front access: If there is an under sink IPS unit, an access hatch is a requirement to allow for installation and routine maintenance of the waste grate.

how to install

Waste Grate Installation

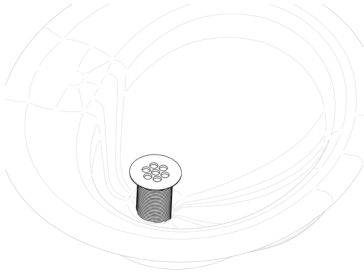

1

Fit waste into basin from top.

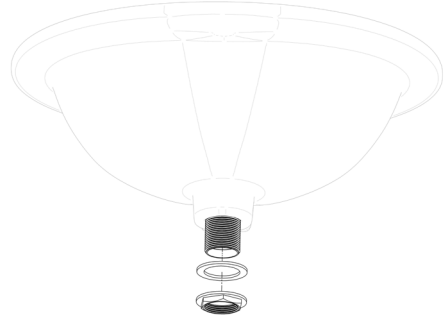

2

Slide sealing washer over thread below basin, and the attached fixing nut and tighten. Take care not to over-tighten as damage may result to the basin.

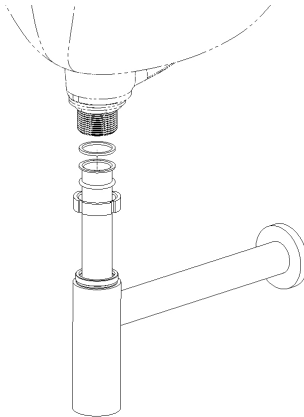

3

Fit waste trap to waste grate, following the trap installation guide.

maintenance

For regular maintenance, the waste grate should be inspected periodically for any blockages. Hairs and other obstructions should be removed from the waste grate to ensure that water drains away. The trap may be required to be removed to allow full access from the bottom of the waste grate. This should be done as required, if it is observed that water is not draining away sufficiently.

cleaning

- + Take extra care when cleaning decorative surfaces.
- + For surface cleaning of the trap use ONLY soap and water, then wipe dry with a clean cloth or towel.
- + DO NOT use steel wool or cleaning agents containing alcohol, acid, abrasives or the like.
- + Use of any prohibited cleaning or maintenance products or substances could damage the surface of the trap.
- + When cleaning bathroom tiles, the traps should be protected from any splattering of harsh cleansers.

All grades of stainless steel will stain or discolour if due care and attention is not taken. The surface must be regularly cleaned to ensure a long service life of the trap.

Use a soft cloth or sponge with a mild solution of soapy water as part of the regular washroom janitorial routine. Do not use abrasive or cream cleaners as these will damage the surface finish.

If the waste grate is subjected to a highly chlorinated environment such as swimming pools or marine coastal locations, a further treatment, in addition to the regular cleaning as described above, is recommended by the application of a household cleaning product containing silicone.

If further information is required, contact The Splash Lab technical team for more detailed stainless steel care guidelines.

warranty

We believe the future is personal. With a global mindset, we challenge conventional restroom norms via product innovation to create considered washroom solutions for corporate, public and hospitality spaces. We use rich raw materials, cutting-edge automation and considered washroom design to powerfully and positively influence the lives of people.

Demonstrating our commitment to quality and our belief in the strength of our designs, we offer the following warranties.

The Splash Lab warrant that its products will be free of manufacturing and material defects during normal use and environmental conditions as detailed below:

Waste Grate: 2 years parts & labour

If a defect is found in normal use, The Splash Lab will, at their discretion, repair, provide a replacement part or product, or make appropriate adjustments. Damage caused by accident, misuse, or abuse is not covered by this warranty. Improper care and cleaning will void the warranty.

Non-operation of the product due to environmental conditions beyond our control, installation error, incorrect maintenance, water quality, fair wear and tear, incorrect or inappropriate installation, misuse and abuse is not covered by the warranty.

Proof of purchase (original sales receipt) must be provided to The Splash Lab with all warranty claims.

The above warranty is valid for goods supplied within the United Kingdom.

For goods supplied outside of the United Kingdom, The Splash Lab will honour the above stated warranty periods for the parts only.

THE SPLASH LAB DISCLAIM ANY LIABILITY FOR SPECIAL, INCIDENTAL OR CONSEQUENTIAL DAMAGES.

contact



General information

info@thesplashlab.com

+44 (0) 161 482 7000

Technical support

technical@thesplashlab.com

For further contact information visit:

www.thesplashlab.com

